

Available

# 70 Acre Canadian National Railroad-Served Terminal Near Intersection of I-80 & I-55



## PROPERTY SPECIFICATIONS

8920 North Tabler Road  
Channahon, Unincorporated Grundy County, IL

- 693,000 SF facility
- 20'-50' clear height
- State of Illinois Enterprise Zone (eliminates sales tax on natural gas & other benefits)
- Visibility & Frontage on US 6 near I-80 & I-55 interchanges
- 10 miles west of UP Joliet and BNSF LPC Intermodal Terminals
- Ideal for trailer storage & bulk transload of bulk commodities including grain, plastics, aggregates & liquids
- 13.2 KVA electric service

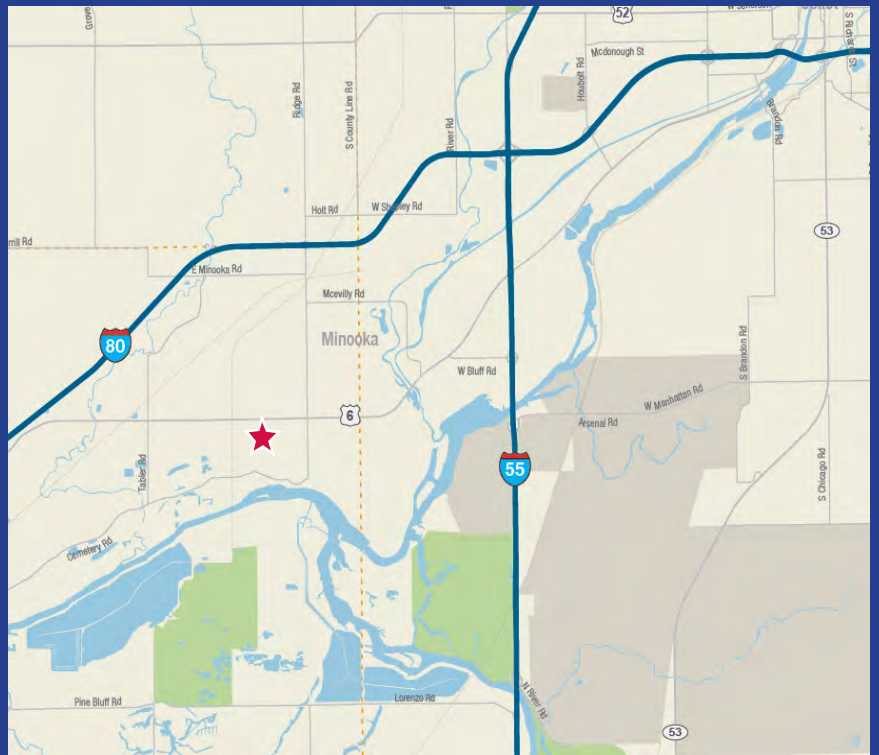

Information contained herein is from sources we deem reliable and assume no liability for errors or omissions is. Price subject to change and listing may be withdrawn without notice.



Available

# 70 Acre Canadian National Railroad-Served Terminal Near Intersection of I-80 & I-55

